



## NWA1123-AC PRO

### 802.11ac Dual-Radio Dual Mount PoE Access Point

#### Introducing the new hybrid access point

The Zyxel Hybrid series allows devices like the NWA1123-AC PRO to be used in two modes by utilizing Zyxel's **NebulaFlex™**, you are able to easily switch between standalone and our License Free Nebula cloud management platform, anytime, with a few simple clicks.

By allowing the two different modes, you are able to protect your investment in wireless technology by having the flexibility to benefit from the cloud in your own time, without the need to worry about additional ongoing licensing costs.

When used with Nebula you are able to centrally manage, access real-time network information and gain effortless control over the NWA1123-AC PRO and other Hybrid and Nebula devices, all under a single intuitive platform without the need to install any software or add additional equipment like a controller.

#### Not ready for the cloud... Just yet?

For those of you who are not ready for the cloud the NWA1123-AC PRO offers a standalone mode, allowing you to setup each AP via its local user-friendly web interface and setup wizard. The wizard will quickly guide you through the initial setup and have you up running in minutes. Additionally you can manage and monitor the AP via traditional SNMP methods that you may have already in place. The NWA1123-AC PRO is also part of the Zyxel One Network. This means that you can use the complimentary Zyxel One Network Utility to help with repetitive operations during deployment.

**NebulaFlex™** gives you the flexibility to switch between standalone and our License Free Nebula cloud management



Nebula cloud management allows easy deployment, real-time configurations and access to all your access points anytime with



Dual-optimized antenna for optimal performance in wall/ceiling-mount installations



802.11ac 3x3 — supporting combined data rate of up to 1.75 Gbps



Robust build quality including solid-state capacitors to ensure long life and operational reliability



What to benefit from Cloud central management?

When you're ready to join our Nebula cloud management solution, simply register your NWA1123-AC PRO\* via Nebula Control Center and the device will automatically join, auto provision and begin to give real-time information. The intuitive platform allows you to group your access points together, control centrally, gain access to diagnostics

tools and additional features like captive portal all under a single platform.

The Nebula platform has no limits to how many access points can be added, giving you an easy to use, scalable platform that you can access anytime, anywhere.

\*: Requires 5.20 version of firmware



Dual-optimized antenna — performance for wall or ceiling-mount installations

Most access points are designed to have a static radiation pattern, which is normally optimized for ceiling-mount installations. This means that when an AP is fitted on a wall, the optimum signal from the AP is lost to the upper and lower floor, rather into the area you want to cover.

The NWA1123-AC PRO has the ability to select ceiling-mount mode or wall-mount mode giving you the option to select the optimum radio pattern for its installation. This allows greater coverage to reach clients in the desired area along with reducing the risk of creating interference regardless of mounting (wall or ceiling).

Traditional (Side View)  
Pattern for wall-mount  
(H-plane, side view)

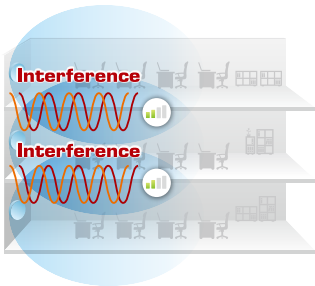

Dual-optimized (Side View)  
Pattern for wall-mount  
(H-plane, side view)

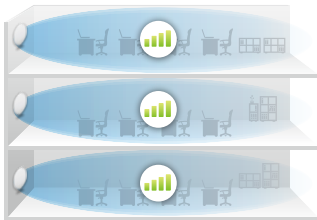

Traditional (Top View)  
Pattern for wall-mount  
(E-plane, top view)



Dual-optimized (Top View)  
Pattern for wall-mount  
(E-plane, top view)

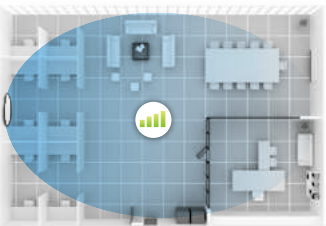

## Ultra-slim exterior design

Zyxel Nebula NWA1123-AC PRO's ultra-slim exterior (32 mm in height) and understated white color blend perfectly into all kinds of decorations in various buildings with extraordinary modern tastes. The compact, elegant aesthetics makes NWA1123-AC PRO suitable for different decors no matter it's meant to be visible or not.



## RF First — high performance and reliable connections through design

With Zyxel's innovative design and commitment to "RF First" for high performance and reliable connections through design, the NWA1123-AC PRO delivers increased coverage and improved connection speeds for every client.

When designing an access point, every hardware design element including the layout and the antenna are all taken into account to ensure that we lead with user experience and gain not only in coverage but also in performance that maximizes the experience in the real world.

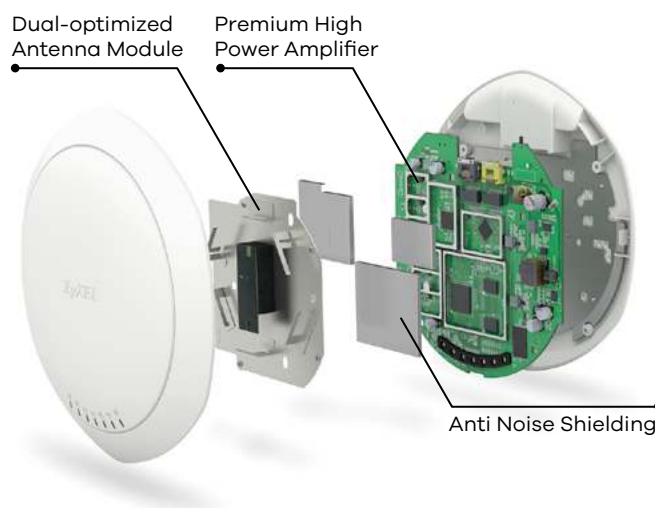

## Wireless built for user experience

The NWA1123-AC PRO ensures an optimized wireless experience for users by combining wireless technologies like Dynamic Channel Selection (DCS), Load Balancing. DCS minimizes the interference of co-channel and overlapping channels, while Load Balancing enables administrators to easily set limits on the number of clients associated with each AP. These advanced functions ensure that users can enjoy a smooth, consistent and uninterrupted wireless experience.

## Flexible operating modes

The NWA1123-AC PRO not only offers two different styles of management via **NebulaFlex™** (cloud or standalone). The NWA1123-AC PRO also offers the ability to use the AP as a repeater/root-AP<sup>\*1</sup> compatibility with Zyxel's Unified Pro Series and Unified Series APs<sup>\*2</sup>. By taking advantage of these features, users can extend wireless connectivity to challenging locations by wirelessly bridging the devices together without the need to use cables.

<sup>\*1</sup>: Access point must be in standalone mode

<sup>\*2</sup>: For standalone series AP, NWA1123-AC PRO is only compatible with NWA1123-ACv2.

Applications Diagram

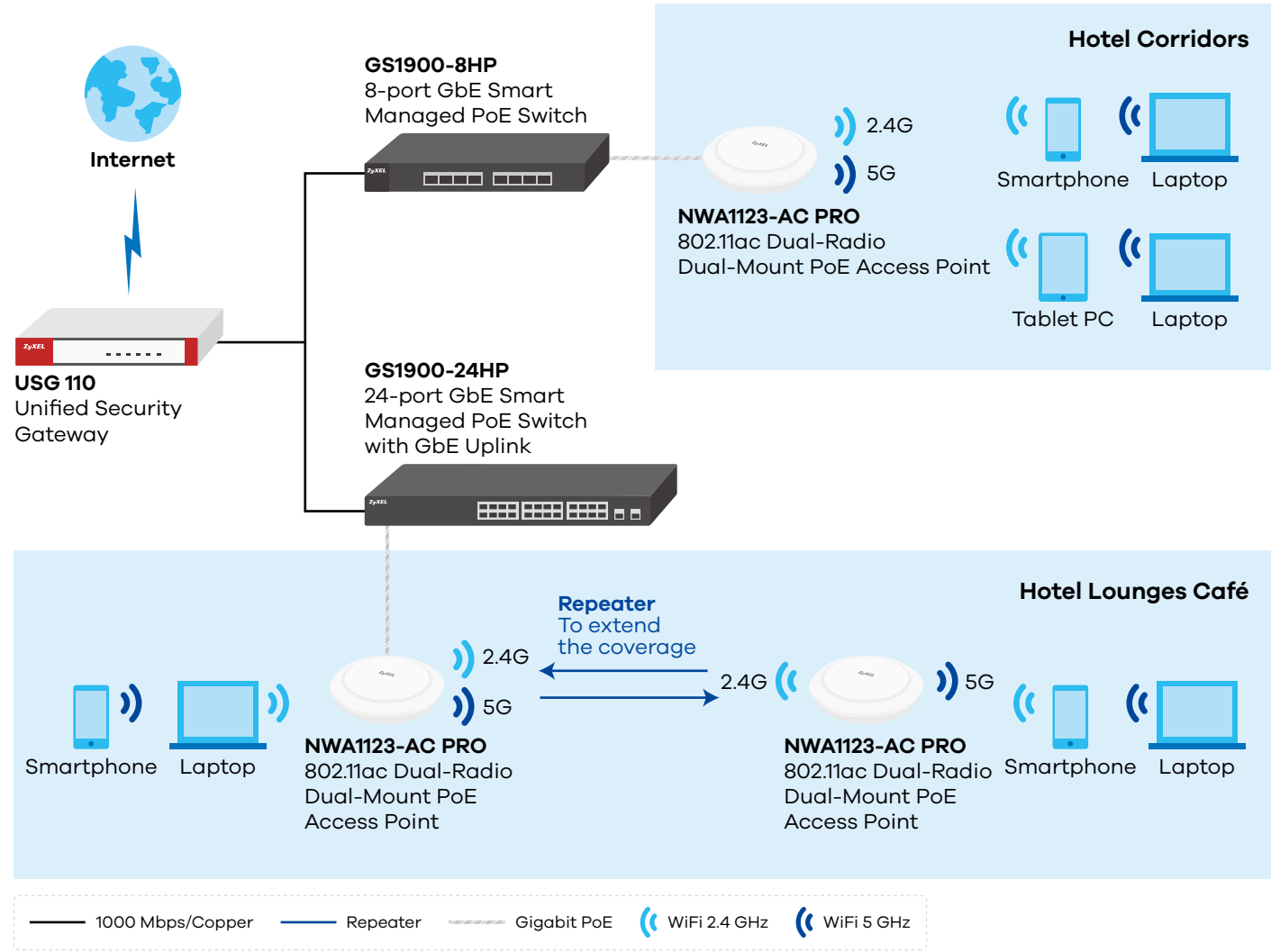

## Specifications

Model		NWA1123-AC PRO	
Product name		802.11ac Dual-Radio Dual-Mount PoE Access Point	
			
Main Design			
Wireless frequency		2.4 GHz & 5 GHz	
Radio		2	
RF Specifications			
Frequency band	2.4 GHz (802.11 b/g/n)	<ul style="list-style-type: none"><li>• USA (FCC): 2.412 to 2.462 GHz</li><li>• Europe (ETSI): 2.412 to 2.472 GHz</li></ul>	
	5 GHz (802.11 a/n/ac)	<ul style="list-style-type: none"><li>• USA (FCC): 5.15 to 5.25 GHz; 5.725 to 5.850 GHz</li><li>• European (ETSI): 5.15 to 5.35 GHz; 5.470 to 5.725 GHz</li></ul>	
802.11 premium features		<ul style="list-style-type: none"><li>• 3x3 Multiple-Input Multiple-Output (MIMO) with three spatial streams</li><li>• Maximal Ratio Combining (MRC)</li><li>• 20-, 40- and 80-MHz channels</li><li>• PHY data rates total up to 450 Mbps (11n) + 1.3 Gbps (11ac)</li></ul>	<ul style="list-style-type: none"><li>• Packet aggregation: A-MPDU (Tx/Rx), A-MSDU (Tx/Rx)</li><li>• Cyclic Delay diversity (CSD) support</li><li>• Maximum Likelihood Demodulation (MLD) support</li><li>• Low Density Parity Check (LDPC) support</li></ul>
Conducted typical transmit output power*1	US (FCC) 2.4 GHz	27 dBm	
	US (FCC) 5 GHz	27 dBm	
	EU (ETSI) 2.4 GHz	18 dBm	
	EU (ETSI) 5 GHz	24 dBm	
Number of antenna		3T3R MIMO	
Antenna gain	2.4 GHz	<ul style="list-style-type: none"><li>• Ceiling: 3 dBi</li></ul>	<ul style="list-style-type: none"><li>• Wall: 4 dBi</li></ul>
	5 GHz	<ul style="list-style-type: none"><li>• Ceiling: 4 dBi</li></ul>	<ul style="list-style-type: none"><li>• Wall: 5 dBi</li></ul>
Support data rate		<ul style="list-style-type: none"><li>• 802.11a/g: 1, 2, 5.5, 6, 9, 11, 12, 18, 24, 36, 48, and 54 Mbps</li><li>• 802.11n: up to 450 Mbps in MCS15 (40 MHz)</li><li>• 802.11ac: up to 1300 Mbps in MCS9 (80 MHz)</li></ul>	
RF Specifications			
Receive sensitivity		Min. Rx sensitivity to -102 dBm	
LAN			
Number of 10/100/1000M LAN		2	
PoE		Yes	
PoE power draw		12.48W (802.3at PoE)*2	
WLAN Security			
WEP		Yes	
WPA/WPA2-PSK		Yes	
WPA/WPA2-Enterprise		Yes	
EAP type		EAP-TLS, EAP-TTLS, EAP-PEAP, EAP-FAST, EAP-AKA and EAP-SIM	
WMM		WiFi compliant	
IEEE 802.1X		Yes	
WLAN Security			
Number of multiple SSID		16	
MAC filtering		Yes	
L2 isolation		Yes, multiple profile	
RADIUS authentication		Yes	

Network		
IPv6 support	Yes	
VLANs	Yes	
DHCP client	Yes	
Zyxel One Network		
ZON Utility	<ul style="list-style-type: none"><li>• Discovery of Zyxel switches, APs and gateways</li><li>• Centralized and batch configurations<ul style="list-style-type: none"><li>▪ IP configuration</li><li>▪ IP renew</li><li>▪ Device reboot</li><li>▪ Device locating</li></ul></li><li>▪ Web GUI access</li><li>▪ Firmware upgrade</li><li>▪ Password configuration</li><li>▪ One-click quick association with Zyxel AP Configurator (ZAC)</li></ul>	
Management		
ZAC <sup>*3</sup>	<ul style="list-style-type: none"><li>• Batch AP configuration</li><li>• Batch AP firmware upgrade</li><li>• Batch AP profile backup</li></ul>	
Standalone AP mode	Yes	
CLI	Yes, SSH	
SNMP	Yes	
Others		
Plenum rating	Yes	
Power supply	802.3at PoE only (No DC jack)	
MTBF (hr)	1,005,235	
Standard Compliance		
Ethernet	IEEE 802.3, IEEE 802.3u, IEEE 802.11ab, IEEE 802.3au, IEEE 802.3az, IEEE 802.3at	
WLAN	<ul style="list-style-type: none"><li>• 802.11b: DBPSK, DQPSK, CCK</li><li>• 802.11g: BPSK, QPSK, 16-QAM, 64-QAM</li><li>• 802.11a: BPSK, QPSK, 16-QAM, 64-QAM</li><li>• 802.11n: BPSK, QPSK, 16-QAM, 64-QAM</li><li>• 802.11ac: BPSK, QPSK, 64-QAM, 256-QAM</li></ul>	
Certifications		
Radio	FCC part 15C, FCC part 15E, ETSI EN 300 328, EN 301 893, LP0002	
EMC	FCC part 15B, EN 301 489-1, EN 301 489-17, EN55022, EN55024, EN61000-3-2/-3, BSMI CNS13438	
Safety	EN 60950-1, IEC 60950-1, BSMI CNS14336-1	
Physical Specifications		
Item	Dimensions (WxDxH)(mm/in.)	203.9 x 191.7 x 34.7/8.03 x 7.55 x 1.37
	Weight (g/lb.)	445/0.98
Packing	Dimensions (WxDxH)(mm/in.)	240 x 235 x 100/9.45 x 9.25 x 3.94
	Weight (g/lb.)	1210/2.67
Included accessories	<ul style="list-style-type: none"><li>• PoE injector</li><li>• Ethernet 45 cable</li><li>• Wall/ceiling mount plate</li></ul>	
Physical Specifications		
Operating environment	Temperature	0°C to 50°C/32°F to 122°F
	Humidity	10% to 90% (non-condensing)
Storage environment	Temperature	-40°C to 70°C/-40°F to 158°F
	Humidity	10% to 90% (non-condensing)

\*1: Maximum output power is limited by regional regulatory.

\*2: Max. power draw is 12.48W. In extreme cases, the inrush current is greater than 802.3af limit, thus 802.3at PoE is required.

\*3: Support from ZAC Utility V1.1.3 or above; support only in standalone mode.

# Weather-Proof Mounting Option

## Outdoor Enclosure

People like to enjoy the combination of great view, fresh air and WiFi service when they're outdoors. This weather-resistant enclosure brings the Zyxel indoor AP outdoors to make deployments in places such as parks, campus, poolside or camping yard convenient and affordable. This enclosure allows the AP to be easily mounted on any wall or pole. The durable enclosure is designed to withstand a wide range of temperature from 50°C to -20°C, waterproof the APs with IPX5 rating certified and extend lifespan with the UV stabilized plastic, which makes it the most reliable weatherproof enclosure.

## Features

- **Compatible with various APs** including unified, cloud-managed and standalone units
- **Wide operating temperature** range from 50°C to -20°C
- **Compact size** easily blends into any environment seamlessly
- **UV stabilized plastic** extends enclosure lifetime
- **Flexible mount design** for wall mount, or pole mount installation with pole mount kit (sold separately)
- **IPX5 rating** makes Zyxel indoor AP weatherproof



Wall mount installation



Pole mount installation

## Specifications

Model	Enclosure
Dimensions (WxDxH)(mm/in.)	238.54 x 249.72 x 86.97/9.39 x 9.83 x 3.42
Weight (kg/lb.)	0.64/1.4
Mounting options	Wall, pole (pole mount kit is sold separately)
Certified	IPX5
Adjustability	Swivel +/-40°; Tilt +/-15°



## Compatibility List

Model
<ul style="list-style-type: none"><li>• NWA1123-ACv2</li><li>• NWA5121-NI</li><li>• NWA5123-AC</li><li>• NAP102</li></ul>
<ul style="list-style-type: none"><li>• NWA1123-AC PRO</li><li>• WAC6103D-I</li><li>• NAP203</li></ul>



# ZYXEL

Your Networking Ally

For more product information, visit us on the web at [www.zyxel.com](http://www.zyxel.com)

Copyright © 2018 Zyxel Communications Corp. All rights reserved. Zyxel, Zyxel logo are registered trademarks of Zyxel Communications Corp. All other brands, product names, or trademarks mentioned are the property of their respective owners. All specifications are subject to change without notice.

Datasheet [NWA1123-AC PRO](#)



5-100-00718011 03/18